

Bertuetti SV300 Universal Dough Divider (Soft & Hard)

10-SV300PM Divider Universal® SV300

Laminating divider for soft and hard doughs, direct or rested doughs; for square and rectangular products.

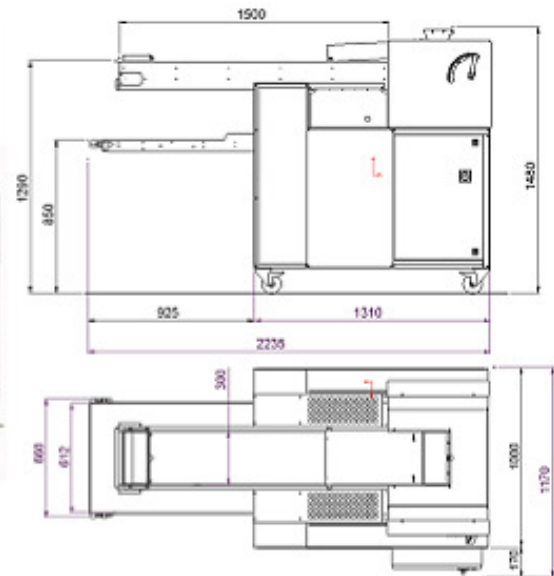

Characteristics:

- feeding belt
- automatic roller clutch control
- stainless steel laminating rollers
- dough thickness manual control on 26 positions
- rollers scrapers
- adjustable top flour duster
- patented system 1 to 7 rows dividing
- adjustable stainless steel dividing discs
- sole spreading unit 1, 2, 3, 6 rows by belts
- guillotine cutting system on roller with scraper cleaner
- flour keeping drawers
- digital control panel with 20 memories
- speed and weight electronic control for each recipe
- adjustable exit belt 850-1290 mm
- stainless steel manufacturing
- assembled on locking wheels
- voltage V 400, Hz 50, 5 poles plug in, CE conformity

Accessories:

- adjustable flour duster by brush on feeding belt (2003-M31)
- belts spreading unit 4 rows (2003-M4), belts spreading unit 5 rows (2003-M5), belts spreading unit 7 rows (2003-M7B)
- equalizer and motorized duster of flour by rollers brush (10-PAR300), equalizer on feeding belt (10-PAR300-1)
- duster of flour by rollers brush assembled later on equalizer frame (15-S25)
- adjustable moulding plate on exit belt, with electronic set (2003-M67)
- duster of flour by rollers brush 60cm on exit belt (15-S20)
- remote divider control (start/stop) on connectable moulders for manual picking
- trolley for exchangeable accessories (spreading units) (20-C0056-062)
- rested dough container (feeding belt size) for manual feeding, trolley for 24 dough above containers

Options*:

- longer feeding belt 190 cm (2003-M10), longer exit belt (2003-M57)
- adjustable roller clutch (15-B105-M41)
- high speed guillotine (only for square/short products)
- variable exit belt speed
- dividing rollers system 8 rows with spreading unit (2003-M54)
- sole spreading unit by springs
- opposite side handle and control panel
- adjustable feet
- touch-screen control panel (needed for lines with more than 2 units)
- different voltages (to specify)

Possible connections: feeders AL, SAL, long moulders F, FS, FR, T116, 2104, 2085, rounders G12, G13, stamping K4, seeder SS, tray loader N16, STR, setters loader PROMETEO, STR

Packing crates: pallet dimensions cm 235 x 130, open crate inside dimensions cm 235 x 130 x 125

Dough water content	%	< 80
Dough useful width (rollers width)	mm	300
Adjustable lamination thickness	mm	5-28
Spreading units (optional)	nr	1-7
Weight range	gr	20-2000
Productivity (50 gr)	pos/h	15000
Productivity	kg/h	750
Weight	kg	580
Power installed	Kw	1